

# ULTRA-FAST COOKING OVEN (CONVECTION + MICROWAVE)

## ST - F 32 BLACK V24



Ref: 710920



### TECHNICAL CHARACTERISTICS

Internal dimensions	(W)420 x (D)505 x (H)168 mm
External dimensions	(W)525 x (D)740 x (H)580 mm
Total power	7.000 W
Convection power	3.200 W
Microwave power	2.000 W
Maximum temperature	275 °C
Weight	84 Kg
Voltage	400 V - 50/60 Hz
Connection	Three phase 3F+N+T



### DESCRIPTION

Ultra-fast cooking oven (convection + microwave) with capacity for up to 1 tray of 400x400 size, designed to guarantee shorter cooking times than conventional ovens. It has a high-resolution touch panel that will allow you to control all aspects of the oven quickly, intuitively and easily. With its wifi connectivity you can control any aspect of the oven remotely from anywhere with an internet connection.

### CAPACITY

• 1 x 400x400 mm tray



### STANDARD EQUIPMENT

- High resolution touch panel
- Cyclonic cooling system
- Integrated catalytic converter
- Integrated Wifi connection
- High thermal insulation
- Integrated USB port
- HACCP data download capability
- Cloud connectivity
- Average power consumption in maintenance mode 0,9 kWh

### FEATURES

- **CONVECTION MODE:** in this mode, only the heating element of the appliance will be activated to cook the food.
- **CONVECTION + MICROWAVE MODE:** in this mode, the microwaves are activated together with the heating element of the appliance.
- **MAINTENANCE MODE:** allows you to keep the inside of the oven chamber always at the right temperature before starting the desired recipe.
- **COOLING:** allows you to cool the inside of the oven chamber more efficiently.
- **RECIPEBOOK:** with its integrated recipe book, you can store up to 300 recipes with up to 9 different phases each.
- **MESSAGES AND NOTIFICATIONS:** possibility of sending messages and notifications to the oven screen from an external device.
- **GEOLOCATION:** you will be able to geolocate the oven thanks to its connectivity with Connecty.Cloud.

### INCLUDED ACCESORIES

- **PADDLE ST-F 32** – Ref 710944



- **INOX TRAY**



- **TEFLON TRAY PERFORATED BOTTOM** - Ref. 710949



### CERTIFICATE



# OPTIONALS ACCESORIES

## ST - F 32 BLACK V24



### STANDS



ST-F 32  
Ref.710927

(W)525x(D)700x(H)950mm

### UPPER ACCESSORY



ST-F 32  
Ref.710933

(W)530x(D)635x(H)55mm



ST-F 32 BLACK  
Ref.710941

(W)530x(D)635x(H)55mm

### TRAYS



NON-STICK ALUMINIUM  
PADDLE  
Ref.710885

425X295 mm



TEFLON TRAY PLAIN  
BOTTOM  
Ref.710950

265X265 mm

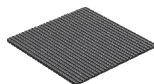

NON-STICK ALUMINIUM  
TRAY  
Ref.710884

310X295 mm

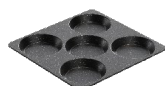

5 EGGS TRAY  
Ref.710882

280X290 mm

### REINFORCED TRAYS



TEFLON TRAY  
REINFORCED PLAIN  
Ref.710947

380X380 mm



TEFLON TRAY  
REINFORCED  
PERFORATED  
Ref.710948

380X380 mm

### STARTERT KIT



### ADHESIVE TEFLONS



ST-F 32  
Ref.710942

Adhesive Teflon Oven Liners ST  
Fast

### VENTILATION DUCT



ST-F 32  
Ref.710936

(W)525x(D)40x(H)150mm



ST-F 32 BLACK  
Ref.710937

(W)525x(D)40x(H)150mm

### PANS



NON-STICK ROASTING  
AND BAKING PAN Ø19  
CM  
Ref.710881

190X190 mm



NON-STICK ALUMINIUM  
PAN SQUARE PLAIN D  
3MM.  
Ref.710879

260X260 mm



NON-STICK ALUMINIUM  
PAN SQUARE GRATED D  
3MM.  
Ref.710880

260X260 mm



NON-STICK ALUMINIUM  
BOWL D 5 MM.  
Ref.710883

240X150 mm

### PINCH



PINCH  
Ref.710878

### STARTER KIT ARTICLES

### REFERENCES

PINCH	710878
NON-STICK ALUMINIUM BOWL	710883
NON-STICK ALUMINIUM TRAY	710884
TEFLON TRAY PLAIN BOTTOM	710755

# CE CERTIFICATE

## ST - F 32 BLACK V24



### **DECLARACIÓN UE DE CONFORMIDAD**

### **EU DECLARATION OF CONFORMITY**

Directiva(s) del Consejo con la(s) que se declara conformidad:

Council Directive(s) to which conformity is declared:

**DC 2014/35/EU + DC 2014/30/EU + DC 2011/65/EU**

Aplicación de las Normas:

Application of the Standards:

**UNE-EN 60335-1:2012 + AC:2014 + A11:2014 + A13:2017 + A14:2014 + A2:2020 + A1:2020; UNE-EN 60335-2-42:2004 + Corr:2007 + A1:2008 + A11:2012; UNE-EN 55014-1:2017 + A11:2021; UNE-EN 55014-2:2015; UNE-EN 61000-3-2:2014; UNE-EN 61000-3-3:2013 + A1:2020**

Fabricante / Manufacturer's  
name:

**FM CALEFACCIÓN S.L.**  
**CIF: B-14343594**

Dirección / Manufacturer's  
address:

**CTRA. de Rute km.2.700, C.P.:14900, Lucena**  
**Córdoba, España**

Tipo de aparato / Type of  
device:

**HORNO / OVEN**

Marca / Trade.:

**FM CALEFACCIÓN**

Modelo / Model no.:

**ST - F 32 BLACK V24**

**N/S: 24XXXXXXXXXX**

**Nosotros, los abajo firmantes, declaramos bajo nuestra exclusiva responsabilidad que el equipo especificado cumple con la(s) Directiva(s) y Norma(s) mencionadas**

**We, the undersigned, hereby declare under our sole responsibility that the specified equipment is in conformity with the above Directive(s) and Standard(s)**

Lugar / Place:

**Lucena**

Firma / Signature: **B-14343594**

Fecha / Date:

**15/01/2024**



TECHNICAL CHARACTERISTICS

ST - F 32 BLACK V24

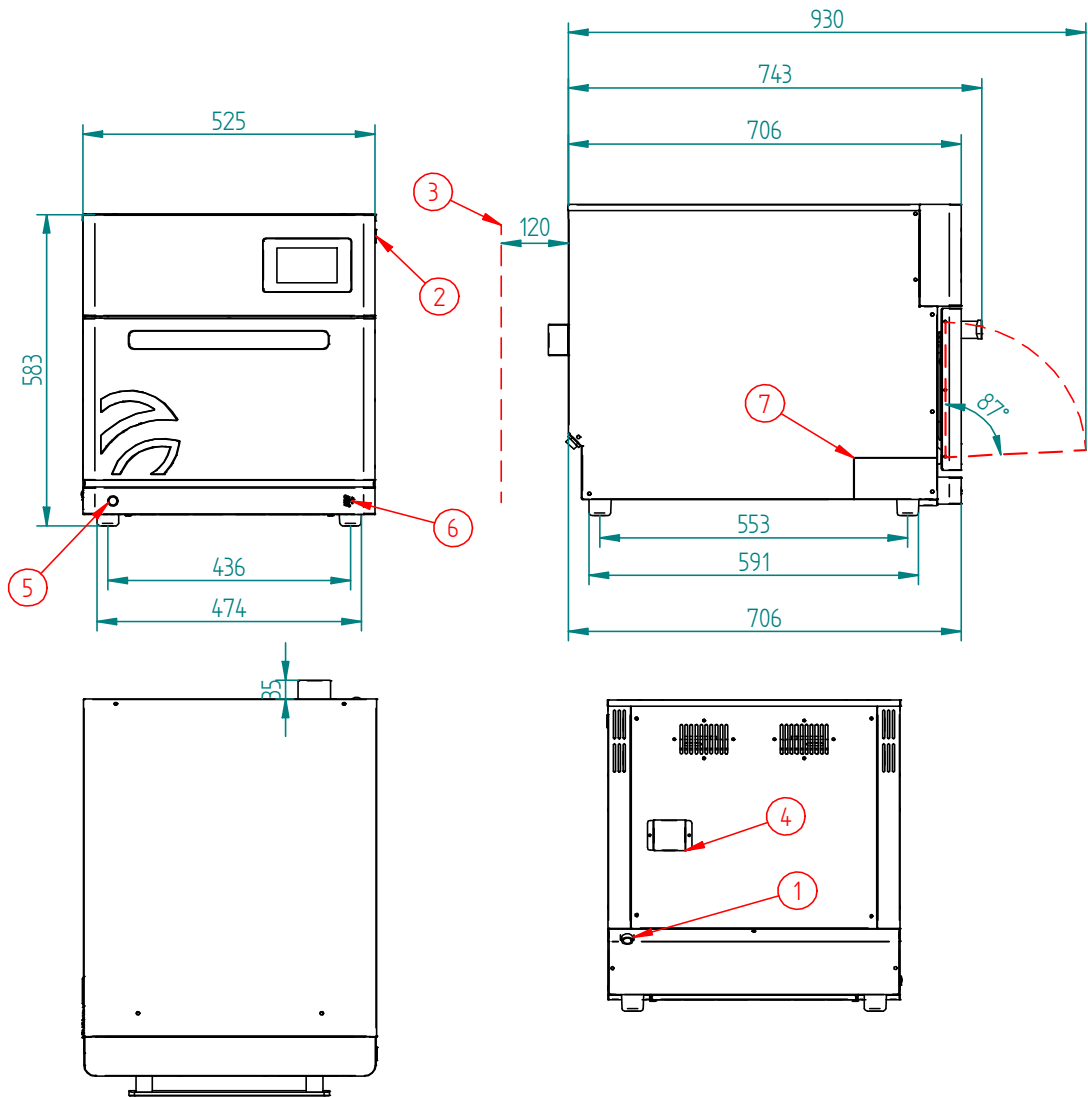

\*Dimensions in mm

TECHNICAL CHARACTERISTICS		
Net weight (only oven)		
Gross weight (oven + packaging)		
Supply voltage	400Vac - Three phase	
Frequency	50Hz	
Power cable	Hose 3F+N+T 4mm2	
Sound pressure level	Below to 70dB	
Total power	7.000W	
Convection power	3.200W	
Microwave power	2.000W	
Average consumption in maintenance mode	0,9 kWh	

CONEXIONADO	
1	Hose connection
2	On/off button
3	Safety gap≥120mm
4	Hot fumes outlet Ø12mm
5	Safety thermostat reset (behind the cover)
6	USB/HACCP Connection
7	Nameplate
CONNECTION TYPES	
Plug type CETAC 32 A	
Magnetothermic type D20A or C25A	